

Emergency Evacuation

Safety Equipment Sales, Training, Gas Monitors, Personal Protective Equipment, Service, Hire, Installation, On-Site Inspection and Advice
Approved & Accredited by

WorkSafeGEAR[®]

com[®]
A division of HeighTech Safety Systems
www.worksafegear.com

info@worksafegear.com Safety Line: +61 8 9314 3377 Fax: +61 8 9314 3244

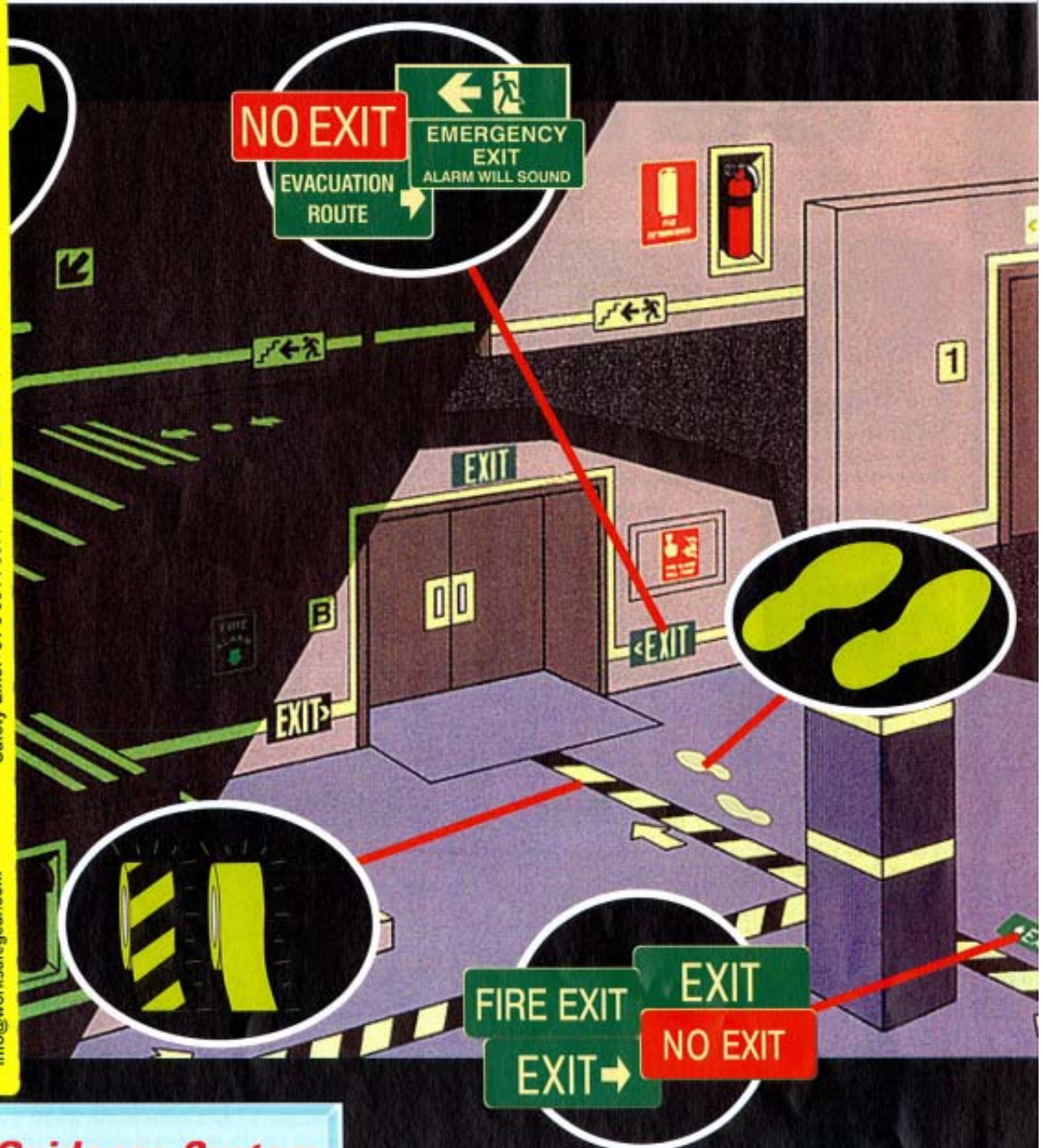

Safety Guidance System

Products that help people find their way out... quickly and safely

Emergency Evacuation is of critical importance to all businesses in Australia today. Brady leads the way to safety with our range of BradyGlo™ photoluminescent technology. This advanced safety guidance system ensures that all employees, visitors and emergency services can easily locate exits and fire fighting equipment in the event of an emergency. BradyGlo™ features a superior, high intensity glow for 10+ hours and easily recharges by absorbing ambient light. It is non-toxic, non radioactive and explosion safe.

The BradyGlo™ Advanced Safety Guidance System creates a continuous, illuminated escape route that is visible in darkness and below smoke. Use BradyGlo™ tapes for continuous emergency egress on walls, stairwells and handrails, BradyGlo™ signs for clear and concise direction and to identify means of egress and fire protection. BradyGlo™ also comes in dots, arrows and floor markings.

Lead the way to safety in your facility with BradyGlo™

BRADYGLO™ LUMINOUS PRODUCTS**GLOW-IN-THE-DARK TAPES (B-324)**

Size	Part Number			Price (ex GST)	
50mm	76430	90971	90973	76432	\$79.90
75mm	76431	90972	90974	76433	\$115.00

STANDARD PACKAGE: 1 roll of 4.5M

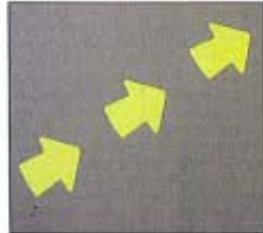
"Glow-in-the-dark"
Phosphorescent Arrows"Glow-in-the-dark"
Phosphorescent Footprints**GLOW-IN-THE-DARK FOOTPRINT & ARROWS (B-324)**

Part Number	Description	Size (mm)	Quantity per roll	Price (ex GST)
93275	Phosphorescent Arrows	75mm	100	\$149.00
55358	Phosphorescent Footprint Left	305mm	1	\$8.90
55359	Phosphorescent Footprint Right	305mm	1	\$8.90



Roll

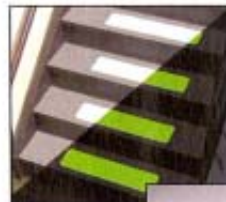

Anti Skid Cleat

GLOW-IN-THE-DARK ANTI SKID TAPE (B-916)

Part Number	Description	Size	Price (ex GST)
99048	Glow-in-the-Dark ANTI-SKID Tape Roll	25mm x 18M	\$59.90
99049	Glow-in-the-Dark ANTI-SKID Tape Roll	50mm x 18M	\$115.00
99050	Glow-in-the-Dark ANTI-SKID Tape Roll	100mm x 18M	\$229.00
99052	Glow-in-the-Dark ANTI-SKID Tape Roll	150mm x 18M	\$345.00
99054	Glow-in-the-Dark ANTI-SKID Cleat	150mm x 610mm	\$659.00
99055	Glow-in-the-Dark ANTI-SKID Cleat	150mm x 610mm	\$139.00

EVACUATION MAP DISPLAY HOLDER

The easy-to-see acrylic board quickly shows viewers the best evacuation route from their work area. Display size: 380mm (h) x 279mm (w)

Part Number	Price (ex GST)
852514	\$59.90

**MEGAPHONES**

These Megaphones will help ensure that communication is clear between the Fire Warden and employees. In the event of an emergency it is important that employees can hear directions to ensure their safety. The Megaphone comes with a push button, volume control incorporated in the handle, 20 watt power as standard. Also available with siren as additional model.

Part Number	Description	Price (ex GST)
852515	Standard Megaphone	\$239.00
852516	Megaphone with Siren	\$259.00

* No Batteries are included: 6 x C Cell Batteries are required to operate Megaphones

RECHARGEABLE AIR HORN

Warn of emergency situations by using this economical and environmentally friendly Rechargeable Air Horn. With a powerful siren emitting 120 dB. of sound, you are sure to be heard. The Air Horn can be stored anywhere and can be used in all weather and temperature extremes. To recharge, simply refill air using the hand pump (included). 100% ozone safe.

Part Number	Price (ex GST)
850342	\$72.50



EXIT AND EVACUATION SIGNS

EMERGENCY EVACUATION

350x180 LUM [™] 835836 350x180 POLY 832736 350x180 LUM [™] 833393	350x180 LUM [™] 835837 350x180 POLY 832704 350x180 LUM [™] 833394	350x180 LUM [™] 835838 350x180 POLY 832706 350x180 LUM [™] 833395	450x180 LUM [™] 835839 450x180 POLY 832738 450x180 LUM [™] 833396	350x180 LUM [™] 841405 350x180 POLY 841406 350x180 LUM [™] 836533	350x180 LUM [™] 841397 350x180 POLY 836740 350x180 LUM [™] 838534
350x180 LUM [™] 841407 350x180 POLY 841408 350x180 LUM [™] 838535 350x180 LUM [™] 843034	350x180 LUM [™] 841403 350x180 POLY 841404 350x180 LUM [™] 838536	450x180 LUM [™] 835840 450x180 POLY 841147 450x180 LUM [™] 833397	450x180 LUM [™] 835841 450x180 POLY 841150 450x180 LUM [™] 833398	450x180 LUM [™] 835855 450x180 POLY 841149 450x180 LUM [™] 833420	450x180 LUM [™] 835854 450x180 POLY 841146 450x180 LUM [™] 833419
450x180 LUM [™] 835857 450x180 POLY 832747 450x180 LUM [™] 833416	450x180 LUM [™] 835850 450x180 POLY 844023 450x180 LUM [™] 836645	350x180 LUM [™] 835851 350x180 POLY 832720 350x180 LUM [™] 834730	350x180 LUM [™] 835853 350x180 POLY 832749 350x180 LUM [™] 833418	350x180 LUM [™] 835852 350x180 POLY 832748 350x180 LUM [™] 833417	350x250 LUM [™] 841148 350x250 POLY 832729 350x250 LUM [™] 833407
450x180 LUM [™] 844386 450x180 POLY 844387 450x180 LUM [™] 844388 450x180 MTL 850942	200x45 SS 841185 400x100 SS 842404	400x100 SS 841182	400x100 LUM [™] 841204	600x450 POLY 835365 600x450 MTL 832491	450x300 POLY 835335 450x300 MTL 841530
450x180 LUM [™] 846138 450x180 LUM [™] 846140 450x180 LUM [™] 846139	400x100 SS 842405 200x45 SS 841184	400x100 LUM [™] 841203			
450x180 LUM [™] 846138 450x180 LUM [™] 846140 450x180 LUM [™] 846139	450x180 LUM [™] 846141 450x180 LUM [™] 846143 450x180 LUM [™] 846142	180x180 LUM [™] 847228 180x180 SS 847229	180x180 LUM [™] 846326 180x180 SS 846327	180x180 LUM [™] 846137 180x180 SS 847230	

FOR PRICING SEE PAGE 228

FLOOR SIGNS

Help direct employees during emergency evacuations with floor signs. Tough, anti-skid over-laminate protects the sign face in high traffic areas. To prolong the life of these signs, use primer and edge sealing compound, apply to a clean, dry, dust-free surface. Not suitable for carpeted areas.

Size: 440x180mm	843305 LUM 843306 SS	843301 LUM 843302 SS	843303 LUM 843304 SS	843313 LUM 843314 SS	843315 LUM 843316 SS

Price (ex GST)

Material	Price
SS-Self Sticker Vinyl	\$38.50
LUM-Self Sticker Vinyl Luminous	\$63.50

LIGHTS ON **LIGHTS OFF**

Glow-In-The-Dark Signs Save Lives In Smoke & Darkness

EXIT LIGHT SIGNS

ECONOMY EXIT SIGN

- Complies with AS/NZS 2293
- Economical choice
- Fixed to mains power with a 2 hour battery backup.
- Dimensions:
 - Single sided - 160mm H x 380mm L x 110mm W.
 - Double sided - 190mm H x 380mm L x 160mm W.

"QUICKFIT" EXIT SIGN

- Complies with AS/NZS 2293
- Be prepared for emergencies
- Indicate all exits and doors
- Dimensions: 218mm H x 374mm L x 72mm W.
- Fixed to mains power with a 2 hour battery backup.

Part Number	Description	Price (ex GST)
842462	Single Sided	\$197.00
842463	Double Sided	\$260.00

Part Number	Description	Price (ex GST)
842465	Single Sided	\$263.00
842467	Double Sided	\$374.00

SAFETY GUIDANCE MARKERS - EXIT SIGNS

851516 450 x 180mm SS ⁽¹²⁰⁰⁾
851410 50 x 100mm SS ⁽¹²⁰⁰⁾851515 450 x 180mm SS ⁽¹²⁰⁰⁾
851411 50 x 100mm SS ⁽¹²⁰⁰⁾851514 450 x 180mm SS ⁽¹²⁰⁰⁾
851412 50 x 100mm SS ⁽¹²⁰⁰⁾B-324 Material, 10⁺ hour glow time.851513 450 x 180mm SS ⁽¹²⁰⁰⁾
851413 50 x 100mm SS ⁽¹²⁰⁰⁾851518 450 x 180mm SS ⁽¹²⁰⁰⁾
851408 50 x 100mm SS ⁽¹²⁰⁰⁾851517 450 x 180mm SS ⁽¹²⁰⁰⁾
851409 50 x 100mm SS ⁽¹²⁰⁰⁾150 x 150mm SS ⁽¹²⁰⁰⁾

Changes to Australian Standard AS 2293.1-2005

Standards Australia has recently revised and modified AS 2293.1 Emergency evacuation lighting for buildings. The modifications in this standard come as a result of changing international trends, it now specifies the use of the "moving person" symbol developed by the International Standards Organisation, instead of the word "EXIT" on illuminated exit signs.

Implementation of this change is expected to become part of the building regulations in the next publication of the Building Codes of Australia (BCA) in 2006. Applications for use of the new symbol in new projects can be made to the BCA now, approval for its' use will be done on a case-by-case basis. For more information, visit www.standards.org.au

IMO FIRE AND EVACUATION SIGNS

- Brady Glo Luminous Material (B-324)
- 10⁺ hour glow in the dark

LUM ⁽¹²⁰⁰⁾ 847540
LUM ⁽¹²⁰⁰⁾ 847541LUM ⁽¹²⁰⁰⁾ 847542
LUM ⁽¹²⁰⁰⁾ 847543LUM ⁽¹²⁰⁰⁾ 847492
LUM ⁽¹²⁰⁰⁾ 847493LUM ⁽¹²⁰⁰⁾ 847494
LUM ⁽¹²⁰⁰⁾ 847495LUM ⁽¹²⁰⁰⁾ 847496
LUM ⁽¹²⁰⁰⁾ 847497LUM ⁽¹²⁰⁰⁾ 847498
LUM ⁽¹²⁰⁰⁾ 847499LUM ⁽¹²⁰⁰⁾ 847528
LUM ⁽¹²⁰⁰⁾ 847529LUM ⁽¹²⁰⁰⁾ 847530
LUM ⁽¹²⁰⁰⁾ 847531LUM ⁽¹²⁰⁰⁾ 847500
LUM ⁽¹²⁰⁰⁾ 847501LUM ⁽¹²⁰⁰⁾ 847502
LUM ⁽¹²⁰⁰⁾ 847503LUM ⁽¹²⁰⁰⁾ 847504
LUM ⁽¹²⁰⁰⁾ 847505LUM ⁽¹²⁰⁰⁾ 847506
LUM ⁽¹²⁰⁰⁾ 847507LUM ⁽¹²⁰⁰⁾ 847508
LUM ⁽¹²⁰⁰⁾ 847509LUM ⁽¹²⁰⁰⁾ 847510
LUM ⁽¹²⁰⁰⁾ 847511LUM ⁽¹²⁰⁰⁾ 847526
LUM ⁽¹²⁰⁰⁾ 847527150x80 LUM ⁽¹²⁰⁰⁾ 847532
150x80 LUM ⁽¹²⁰⁰⁾ 847533LUM ⁽¹²⁰⁰⁾ 847512
LUM ⁽¹²⁰⁰⁾ 847513LUM ⁽¹²⁰⁰⁾ 847514
LUM ⁽¹²⁰⁰⁾ 847515LUM ⁽¹²⁰⁰⁾ 847516
LUM ⁽¹²⁰⁰⁾ 847517LUM ⁽¹²⁰⁰⁾ 847518
LUM ⁽¹²⁰⁰⁾ 847519LUM ⁽¹²⁰⁰⁾ 847520
LUM ⁽¹²⁰⁰⁾ 847521LUM ⁽¹²⁰⁰⁾ 847522
LUM ⁽¹²⁰⁰⁾ 847523LUM ⁽¹²⁰⁰⁾ 847524
LUM ⁽¹²⁰⁰⁾ 847525

These IMO Fire & Evacuation signs have been designed to meet the International Maritime Organisation (IMO) requirements for emergency evacuation procedures as outlined in IMO Resolution 752.A(18)

NON-ELECTRIC EXIT SIGNS

BradyGlo™ Exit signs are made from high performance photoluminescent B-355 material which features a superior glow time of 24+ hours. BradyGlo™ signs absorb and store energy from ambient fluorescent lighting to produce an immediately visible message in the event of dark or smoky conditions. You only need the one legend – handy "pop-out" chevrons make the placement of each sign easy to customise in every situation. These exit signs are non-electric, non-toxic and non-radioactive, saving time and money on energy costs and maintenance checks. Contact your local distributor for a Cost Justification sheet comparing traditional exit lighting solutions with the innovative BradyGlo™ Exit Sign. Available in green and in three styles – Wall mounted, Projecting Single Sided & Projecting Double sided (includes mounting hardware).



* Wall Mounted Signs pictured

Part Number	Description (Green)	Price (ex GST)
90887	Wall Mounted	\$235.50
90841	Single Sided Sign w/bracket	\$280.50
90842	Double Sided Sign w/bracket	\$434.50
90888	Extra Bracket	\$54.90
87806	Clear Mounting Clips - Pack of 4	

FIRE EQUIPMENT SIGNS



**FIRE DOOR
KEEP CLOSED**

300x225 POLY 840694
350x180 SS 833464

**FIRE DOOR
DO NOT BLOCK**

300x225 POLY 840690
350x180 SS 833465

**FIRE DOOR
DO NOT OBSTRUCT**

300x225 POLY 840689
300x225 MTL 840691
350x180 SS 840690
350x180 LUM 847201

**FIRE DOOR
DO NOT OBSTRUCT
DO NOT KEEP OPEN**

300x225 POLY 840992
350x180 SS 840993
350x180 LUM 845887

**SMOKE DOOR
DO NOT OBSTRUCT**

300x225 POLY 840986
350x180 SS 840987



180x180 SS 847353
180x180 LUM 847352



180x180 SS 847351
180x180 LUM 847350



100x400 POLY 834986
100x400 LUM 73520



100x400 POLY 834988
100x400 LUM 73531



100x400 POLY 834989
100x400 LUM 73537



100x400 POLY 841104
100x400 LUM 841105



100x400 POLY 834990
100x400 SS 833456



100x400 POLY 841099
100x400 SS 833455



350 Tri POLY 832800
350 Tri SS 846337



350 Tri POLY 832821
350 Tri SS 846334



350 Tri POLY 832812
350 Tri SS 846332



350 Tri POLY 832826
350 Tri SS 846333



350 Tri POLY 832892
350 Tri SS 847232



350 Tri POLY 832803
350 Tri SS 846331



200 Dia POLY 832898
200 Dia SS 836733



200 Dia POLY 840972
200 Dia SS 840973



200 Dia POLY 832899
200 Dia SS 836731



200 Dia POLY 832897
200 Dia SS 836734



200 Dia POLY 832959
200 Dia SS 836736



200 Dia POLY 832801
200 Dia SS 836732



225x225 POLY 835730



225x225 POLY 835731



225x225 POLY 835732



225x225 POLY 835733



225x225 POLY 835735



225x225 POLY 834619



225x225 POLY 834620



225x225 POLY 834622



225x225 POLY 834623



225x225 POLY 834624



225x225 POLY 834621

EXTINGUISHER I.D NEW ZEALAND



350 Tri POLY 832504
350 Tri SS 846307



350 Tri POLY 832516
350 Tri SS 846309



350 Tri POLY 832515
350 Tri SS 846335



350 Tri POLY 832518
350 Tri SS 846310



350 Tri POLY 841005
350 Tri SS 846306



350 Tri POLY 832508
350 Tri SS 846336



350 Tri POLY 848061
350 Tri SS 848062



350 Tri POLY 848063
350 Tri SS 848064



350 Tri POLY 848065
350 Tri SS 848066

